

Cleaning machine for small scaffolding such as braces

New Cylinder Drum

New Cylinder Drum

Patented

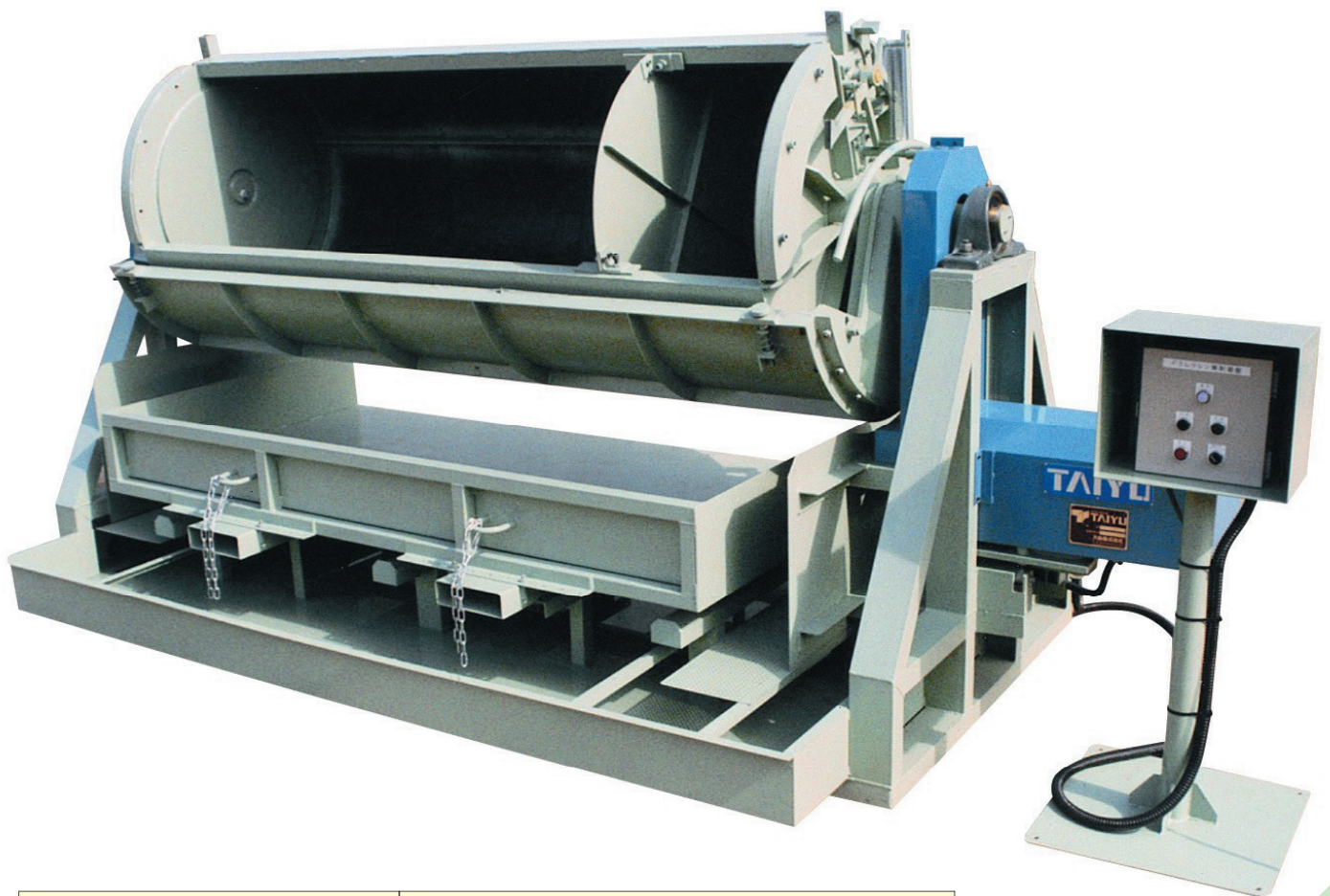

| | | |
|----------------------|---------------------------------|---------|
| Drum diameter | $\phi 1,000 \times 2,500$ mm | |
| Power source | 3-phase, 200 V AC | |
| | Drum rotation | 2.2 kw |
| | Watering pump | 0.25 kw |
| Capacity | Braces: 200 at once | |
| Specified workpieces | Braces and other small hardware | |
| Equipment dimensions | 4,400(W)×1,850(D)×2,110(H)mm | |
| Equipment weight | 2,800 kg | |

※Specifications are subject to change without notice.

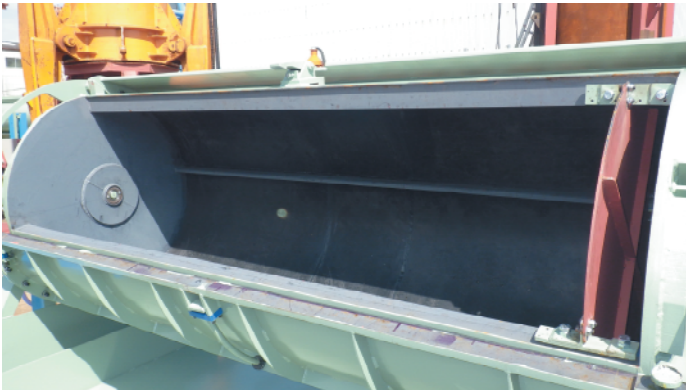
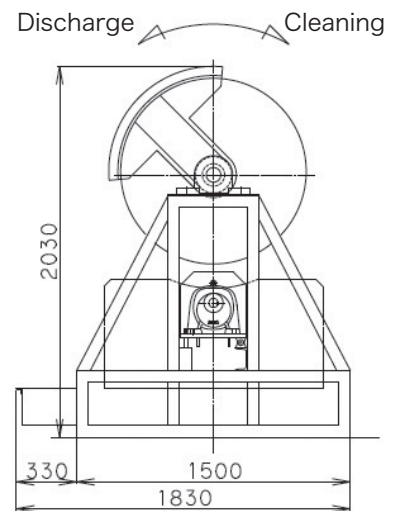
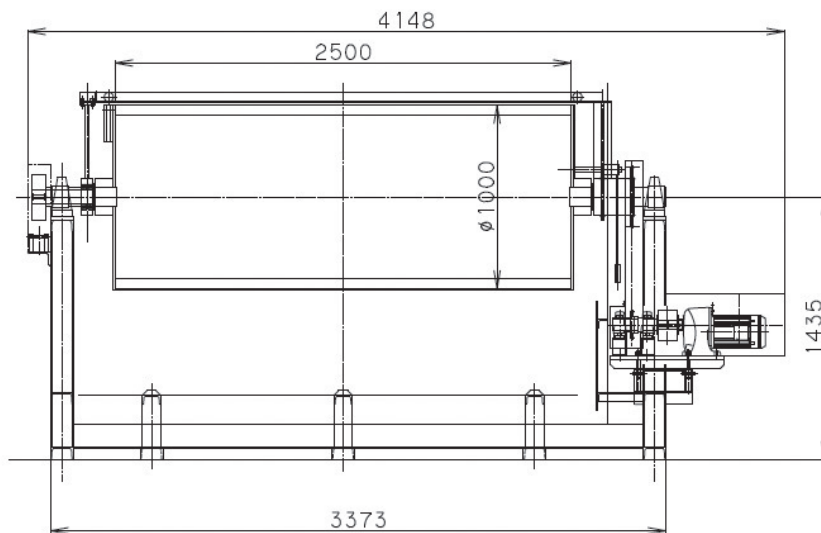

■ Partition plate

Can be set at any position as required.

■ Automatic door

The door opens and closes at the press of a button, automatically discharging workpieces. This design shortens work times while ensuring safety.



■ Circulating water

A pump circulates water for economic operation.